



**MURZAN, Inc.**  
Sanitary Pumps & Systems for Industry

**Murzan PI 50 DL-ST-IF**  
**3" x 3" EP/FL/EP-HT Sanitary Corn Pump** with E.P.D.M. Diaphragms and Gaskets  
For pumping your product.

## **ADVANTAGES OF THE MURZAN CORN PUMP**

- 1) 0% BREAKAGE OF COOKED CORN.
- 2) REDUCES YOUR FRESH WATER REQUIREMENTS POSSIBLY TO ZERO.
- 3) RUNS DRY FOREVER WITHOUT ANY DAMAGE.
- 4) THE PUMP CAN BE LIFTED 27 FEET HIGH ABOVE THE FLOOR AND STILL PULL WATER.
- 5) THE MURZAN PUMP IS AIR DRIVEN; THIS WILL ELIMINATE BURNED MOTORS AND PROBLEMATIC ELECTRICAL CONNECTIONS IN YOUR WET AREAS.
- 6) THE MURZAN PUMP IS COMPACT AND PORTABLE; ONE MAN CAN RELOCATE THE PUMP.
- 7) THE MURZAN PUMP IS COMPLETELY SANITARY AND USDA APPROVED (CAN BE CLEANED IN PLACE WITHOUT DISASSEMBLY).

**Call us Direct @773-882-2308 or Toll Free @1-800-335-Tortilla (8678) ext. 101 to order your New corn Transfer Pump.**



**MURZAN, Inc.**  
Sanitary Pumps & Systems for Industry

### **WHY SHOULD INVEST IN A MURZAN CORN PUMP?**

We have customers in the United States that have reported savings in fresh water usage that range from 200% - 300% by using the Murzan corn pump. The Murzan corn pump can pump your cooked corn (Nixtamal) from your cooker to your washer or mill with the same water that was originally used during the cooking stage. Some recirculation of this water is required. The Murzan corn pump can pump relations as high as 70% solids (corn) and 30% liquids (water) with practically zero damage to the kernel. This will diminish the total solids in your discharge, thereby reducing your sewage bill. Many of our customers have found an economical justification for the use of the Murzan corn pump due to the saving in labor, or by the 5% - 7% reduction of breakage of the kernels after substituting their positive displacement pump in use with the Murzan double diaphragm pump (corn pump). We are enclosing typical system drawings, if you require other components or the complete system to quote, please let us know



**MURZAN, Inc.**  
Sanitary Pumps & Systems for Industry

**PUMP SPECIFICATIONS PI 50 DL-ST-IF 3" X 3" EP/FL/EP-HT  
OPTIONS**

Variable Flow Assembly "E" with stainless steel needle valve

**TERMS**

Delivery Two to three weeks after receipt of  
Purchase order and down payment  
Terms 50% down with Purchase Order  
50% Net 30 Days from Shipment

Terms Note: Our credit terms listed above are subject to change, pending approval by  
our credit department.

We have had customers in the United States that have reported savings on water consumption anywhere from 200 - 300%. Murzan Pumps are capable of pumping Solid/liquid relations of 1/1; this savings is also reflected on your effluent bill. We

have also had reports from our customers, that after changing their positive displacement Pumps to double diaphragm sanitary pumps, they have made savings on breakage of corn that range from 5 - 7%.

# ASSEMBLY "E" COMPONENTS

1. Variable Flow Control
2. Pressure Regulator & Filter
3. Pressure Gauge

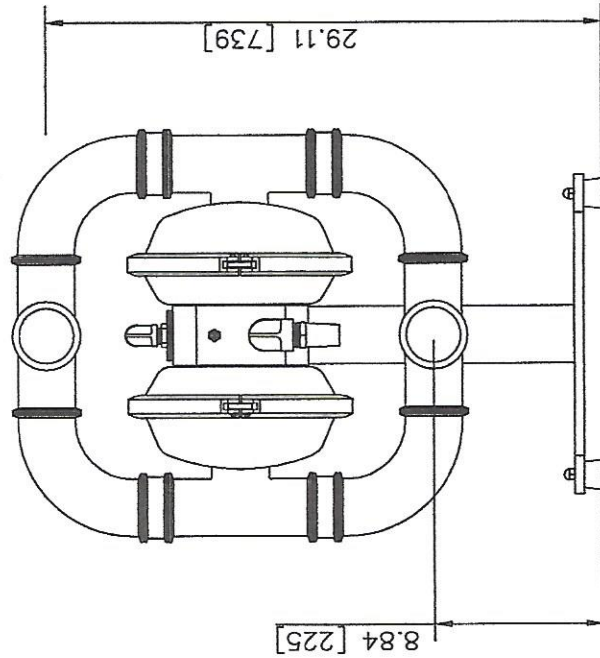
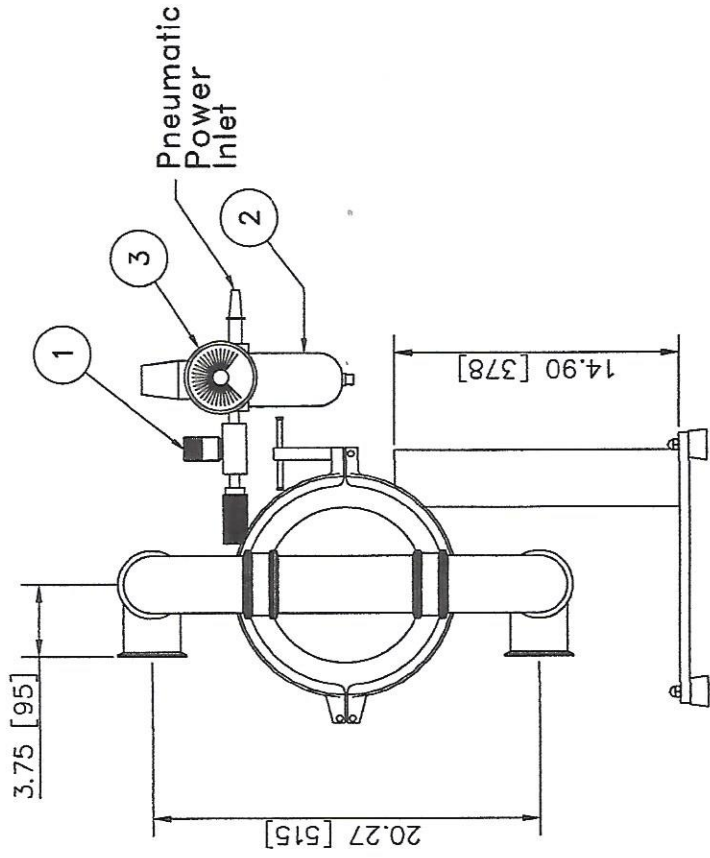
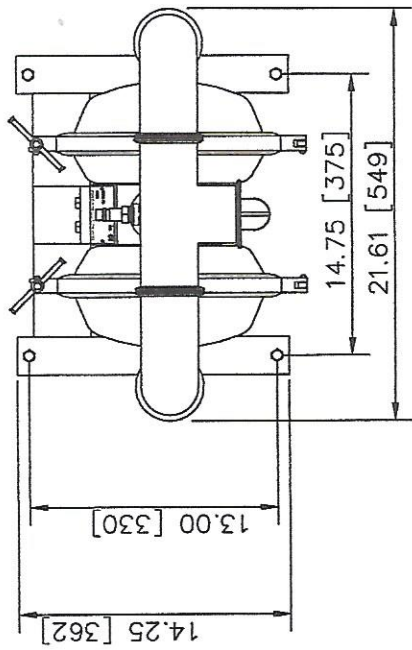

MURZAN PI50-DL/SL-ST-IF 3"X3" PUMP

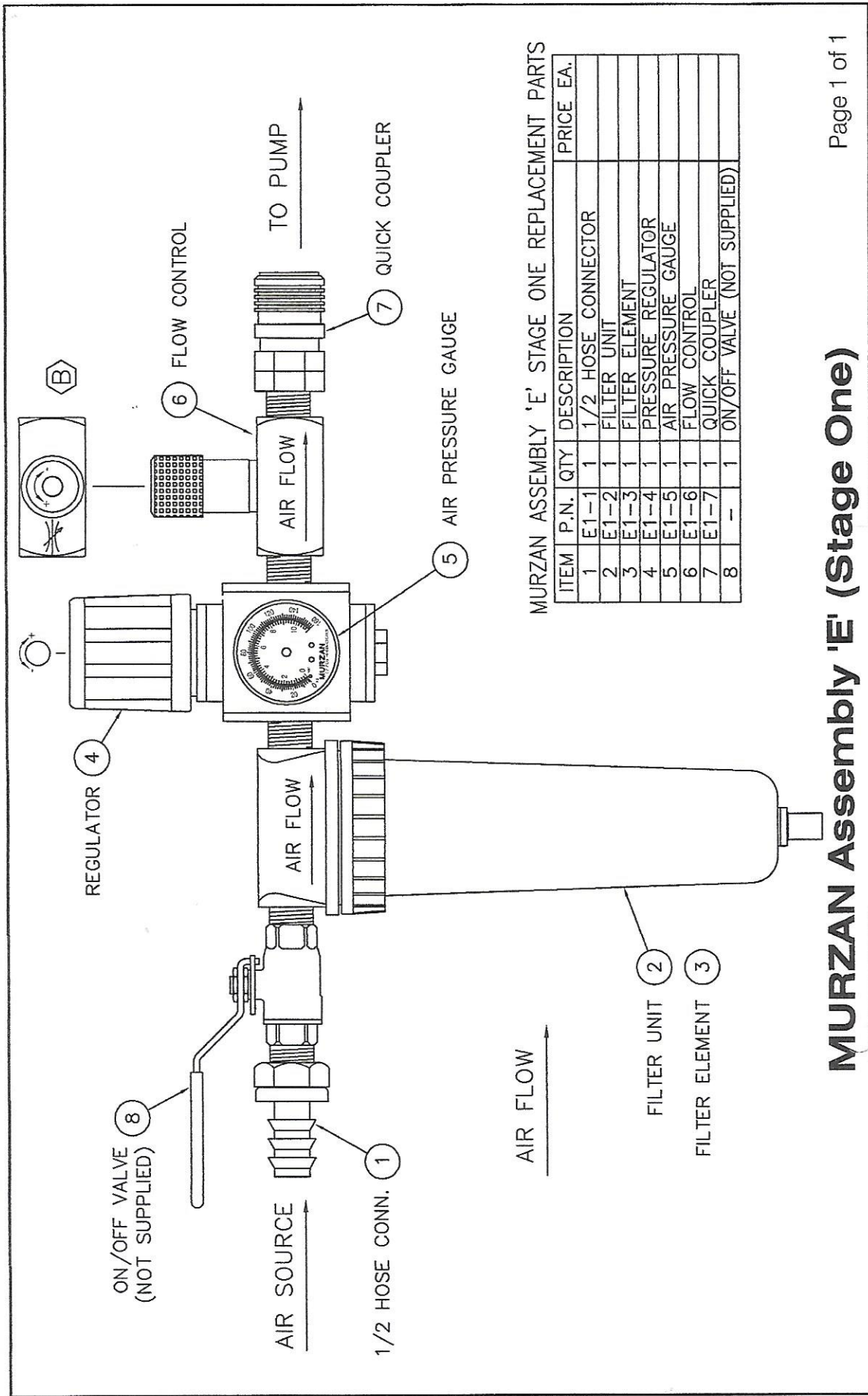

ON/OFF VALVE  
(NOT SUPPLIED)

AIR SOURCE

1/2 HOSE CONN.

AIR FLOW

FILTER UNIT

FILTER ELEMENT

REGULATOR

AIR FLOW

AIR PRESSURE GAUGE

FLOW CONTROL

TO PUMP

QUICK COUPLER